

Sechskantmuttern Kl. 8

DIN 934 DIN-EN 4032

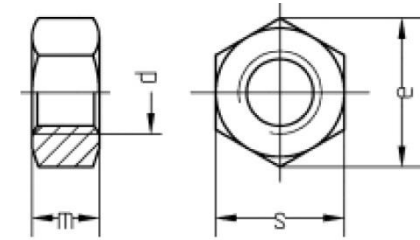

d	M 3	M 4	M 5	M 6	M 8	M 10	M 12
m	2,4	3,2	4	5	6,5	8	10
e	6,01	7,66	8,79	11,05	14,38	18,90	21,10
s	5,5	7	8	10	13	17	19